

<b>To:</b> The Education Resource Sub-Committee	<b>Subject:</b> Proposed Relocation and New Build of Kildrum Nursery Centre
<b>From:</b> Director of Education	
<b>Date:</b> January 2005	
<b>Ref:</b> MM/IS/PH	

## 1. Background

- 1.1 On 21<sup>st</sup> January 2004 the education committee approved the relocation and new build of Kildrum Nursery Centre to an area of ground adjacent to Kildrum Primary School. A copy of that report is attached as appendix 1.
- 1.2 Subsequent investigation has identified difficulties with the proposal. Housing and Property, on progressing the scheme could not adequately fit the nursery onto the area of ground in question (shown as appendix 1 in the report). Significant objections were also received on the planning application due to the loss of open space and closure of a public footpath.

## 2. Proposals

- 2.1 Following further discussions with housing and property and planning and environment it is now proposed that the nursery should be constructed on the south east corner of the original site as shown in appendix 2. It is therefore recommended that the committee approve that the nursery is relocated to this site.
- 2.2 Members should note that this alternative site will fully meet the strategic planning needs for the North Lanarkshire Social Inclusion Partnership.

## 3. Financial Implications

- 3.1 As stated in the original report the possibility of securing part funding from EROF was investigated. Unfortunately this funding was not forthcoming.
- 3.2 The capital cost of the project will be funded from the sure start fund and childcare strategy as shown in appendix 3. Additional revenue costs will also be required due to the increased provision.

## 4. Recommendations

The education committee is recommended to:

- (a) approve the construction of the replacement Kildrum Nursery on the alternative site identified at appendix 2
- (b) approve the funding solution for this project
- (c) note that this project will now be reported to the education sub-committee within the capital monitoring paper

Members wishing further information about this report should contact:

*Michael O'Neill*

Michael O'Neill, Director of Education, on (01236) 812336, or  
Murdo Maciver, Head of Service, on (01236) 812269

**NORTH LANARKSHIRE COUNCIL : DEPARTMENT OF EDUCATION**

**Proposed Relocation and new build of Kildrum Nursery Centre**

**Report by the Director of Education**

**1. BACKGROUND**

- 1.1 Kildrum Nursery Centre opened on 11 October 1999 and was part of the council's expansion programme to meet the national childcare strategy target of every child being guaranteed a nursery place in the term following their third birthday. Provision at Kildrum Nursery Centre was designed to be flexible and meet the needs of the local community by providing services which would be available for 52 weeks. This was a unique facility in the Cumbernauld area at that time.
- 1.2 The centre is located in the grounds of the former Kildrum Primary School. Under the Cumbernauld rationalisation programme Kildrum Primary School relocated to the former Sacred Heart Primary School in April 2001. The original Kildrum Primary School building is currently vacant and approval is being sought from Historic Scotland for listed building demolition consent. Relocation of the nursery centre would increase the anticipated value of the site.
- 1.3 Since opening, there has been a steady increase in the demand for the services provided at Kildrum. The capacity for places for children aged 3-5 years has increased to meet this demand as follows :-
- |              |        |
|--------------|--------|
| 1999/00      | FTE 48 |
| 2000/01      | FTE 56 |
| 2001-Present | FTE 64 |
- 1.4 Currently, there is no provision for children aged 0-3 years in this area, however, a need for services for the very young has been identified as a high priority in the Cumbernauld area.
- 1.5 In 2002/03 approximately 49% of the referrals received for Daycare, a fund that offers essential short-term respite care for families with young children came from the Cumbernauld area. Early monitoring of current daycare cases suggests that this pattern will be replicated this year due to the absence of under three provision. Demand for under 3 services is therefore high in the area.
- 1.6 The provision is inadequate for a number of reasons. Firstly, the fabric of the building is becoming increasingly unfit for the purpose. Secondly, there is no flexibility for services to grow in line with the needs of the area.
- 1.7 Access is a further problem. Because of the sloping site access to the building and movement within it are difficult. The projected cost for solving disabled access problems is over £100,000.
- 1.8 For these reasons a relocation of the centre is considered to be the best value option.

## **2. PROPOSALS**

- 2.1 A suitable site for the new nursery centre has been identified adjacent to the current Kildrum primary school. A site map outlining the location of the current centre and the proposed new centre is included as Appendix A for information.
- 2.2 This new site is located close to the Carbrain community of the North Lanarkshire Social Inclusion Partnership Area.
- 2.3 It is proposed that a new purpose built nursery centre be developed on this new site, providing a range of services for children ages 0-5 years. In addition to providing childcare services the proposed new centre will also have facilities which will allow other agencies including Social Work and Health Services to provide essential intervention with vulnerable families and will contribute to the promotion of better integrated service delivery for children and their families.

## **3. FINANCIAL IMPLICATIONS**

- 3.1 The funding for this redevelopment will be met from the Sure Start and Childcare Strategy budgets 2004/05–2007/08. Additionally, it is considered appropriate to explore the feasibility of applying for ERDF funding under Measure 3 from the Objective 2 West of Scotland Programme. This measure is specifically targeted at areas that have experienced economic and social decline.
- 3.2 The total estimated cost of a new build centre on the proposed site is £900,000. An outline of the proposed funding package is detailed in Appendix B. The possibility of securing ERDF funding is still under discussion, therefore, it was considered appropriate to detail proposed costs, in the first instance, without this level of support.
- 3.3 Further reports will be submitted for consideration once the detail of the funding package is finalised.
- 3.4 All revenue costs will be met from within the existing costs associated with Kildrum Nursery Centre and any additional costs from the Surestart budget. A future paper detailing all associated revenue costs will be brought to future committee for consideration.

## **4. Recommendations**

### **The Education Committee is recommended to:**

- (i) approve the proposed recommendation to progress a new purpose built Kildrum Nursery Centre to replace the existing Kildrum Nursery Centre.
- (ii) note the proposed funding package including the feasibility of E.R.D.F funding.
- (iii) approve the commitment of funding from the appropriate Sure Start and Childcare Strategy budgets.

Members wishing further information should contact:  
Michael O'Neill, Director of Education on 01236 812336 or  
Murdo Maciver, Head of Service on 01236 812269

# Proposed site for New Kildrum Nursery Centre

# Appendix A

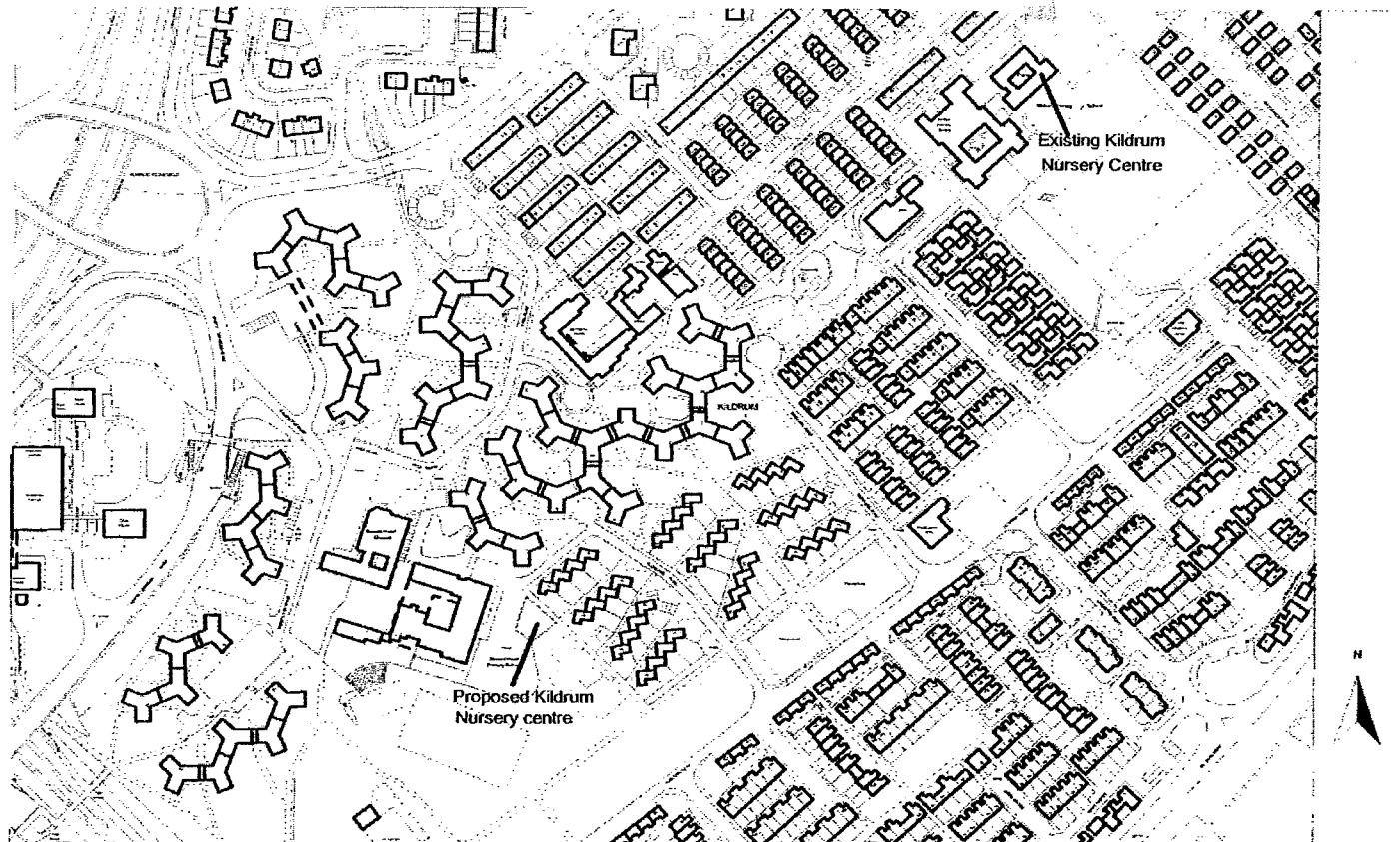

Reproduced from or based upon Ordnance Survey Mapping with the permission of the controller of H.M. Stationary Office. Crown Copyright Reserved. Unauthorised reproduction infringes Crown Copyright and may lead to prosecution or civil proceedings. O.S. License Number LA09041 L.

**Appendix B**

**Total Costs : Capital Project £900,000 (approximately)**

<b>Source</b>	<b>Year 2004/05 £,000</b>	<b>2005/06</b>	<b>2006/07</b>	<b>2007/08</b>
<b>Sure Start</b>	75	300	53	23
<b>Childcare Strategy</b>	75	300	52	22
<b>Total</b>	<b>150</b>	<b>600</b>	<b>105</b>	<b>45</b>

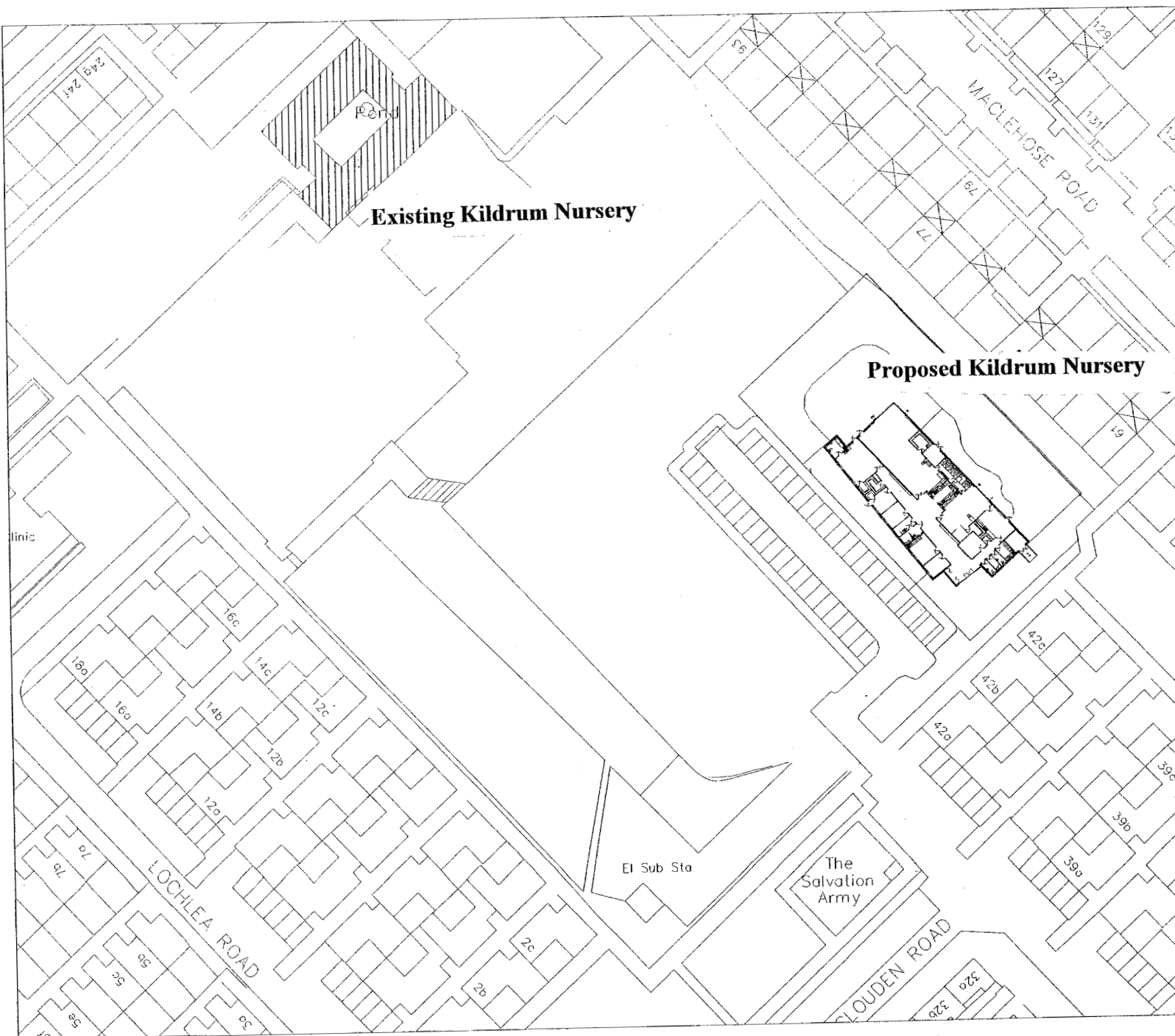

REVISONS			contents
letter	date	By	



HOUSING & PROPERTY SERVICES-DESIGN DIVISION  
 Philip Murray Road, Bellshill, ML4 3PA.  
 Tel : 01698 504000 Fax : 01698 748084

title  
**KILDRUM NURSERY  
 CENTRE,  
 KILDRUM,  
 CUMBERNAULD.**

**ALTERNATIVE SITE  
 OPTION 1 C**

drawn CB	checked
scale 1:500	date

LOCATION PLAN AS PROPOSED.

job number ED/MS/C3/086	rev.
drawing no. AL(0)02	date