

NORTH LANARKSHIRE COUNCIL
REPORT

AGENDA ITEM No. 29

To: HOUSING AND TECHNICAL SERVICES COMMITTEE		Subject: Land Surplus to Requirements
From: DIRECTOR OF HOUSING AND PROPERTY SERVICES		
Date: 4 th February 2003	Ref: TMCK/JS	

1. Introduction

- 1.1 The purpose of this report is to request committee approval to declare areas of land surplus to requirements.

2. Background

- 2.1 The following sites are held within the Housing Revenue Account and are considered to be surplus to requirements. It is therefore proposed to place these areas on the internal surplus property bulletin prior to external marketing.

2.2 Land at 13 Dunottar Place, Shawhead.

The land referred to is identified at appendix 1 and is located adjacent to 13 Dunottar Place, Shawhead. The area extends to 145m² or thereby, is not currently in productive use and an offer has been received from the adjacent occupier to purchase the site for the purposes of extending the garden area. The area is not earmarked for future use.

2.3 Land at 14 Woodhall Place, Kirkshaws, Coatbridge.

The area of land referred to is identified at appendix 2 and is situated at the end of the garden of 14 Woodhall Place. The area is not currently in productive use and is not earmarked for future use.

2.4 Land at Bent Road, Airdrie.

The land referred to is identified at appendix 3 and is accessed via Bent Road the area extends to 100m² or thereby and is not currently in productive use.

2.5 Land at School Street, Shotts.

The land referred to is identified at appendix 4 and is accessed via School Street in Shotts. The area extends to 750m² or thereby and is not currently in productive use. This area may be suitable for a small residential development.

2.6 Land at Viewfield Road, Coatbridge.

The land referred to is identified at appendix 5. The land is not currently in productive use and is not earmarked for any future use. An enquiry has been received regarding its availability for purchase as additional garden ground for the adjacent property.

2.7 Land at McGregor Avenue, Airdrie.

The land referred to is identified at appendix 6. The area extends to 700m² or thereby and is not currently in productive use. An enquiry has been received with regard to its availability for sale for the formation of an access road to adjacent property.

3.0 Recommendation

3.1 It is recommended that Committee approves the proposal to declare surplus to requirements the areas of land referred to in paragraphs 2.2 – 2.7 and that their disposal is progressed in accordance with the Council's policy on surplus land and buildings.

4.0 Access to Information.

4.1 Available within the Department



Thomas McKenzie
Director of Housing and Property Services

Garden Ground at 13 Dunottar Place, Coatbridge

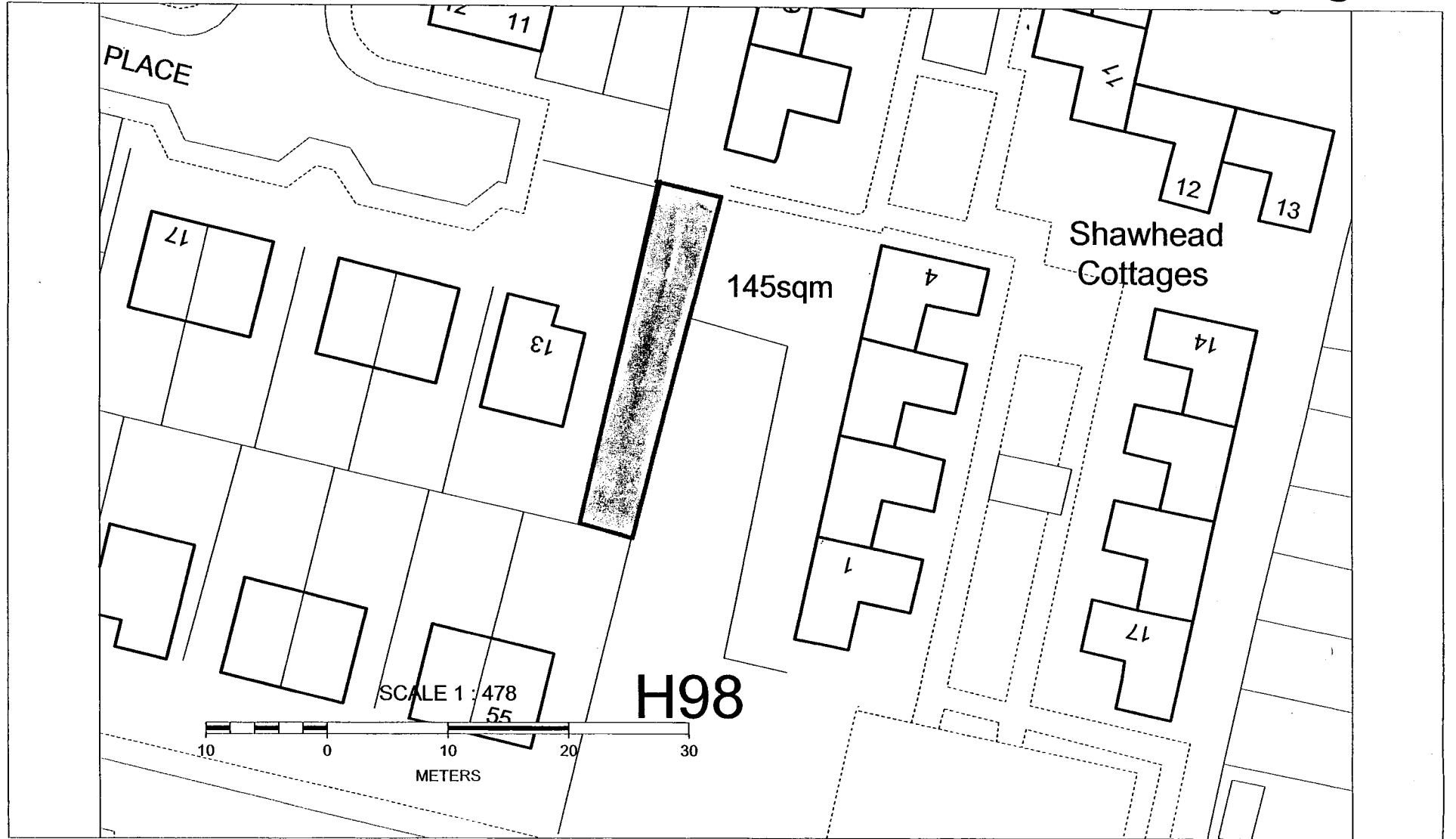

Reproduced from or based upon Ordnance Survey Mapping with the permission of the controller of H.M. Stationary Office. Crown Copyright Reserved. Unauthorised reproduction infringes Crown Copyright and may lead to prosecution or civil proceedings. O.S. License Number LA09041L.

Property

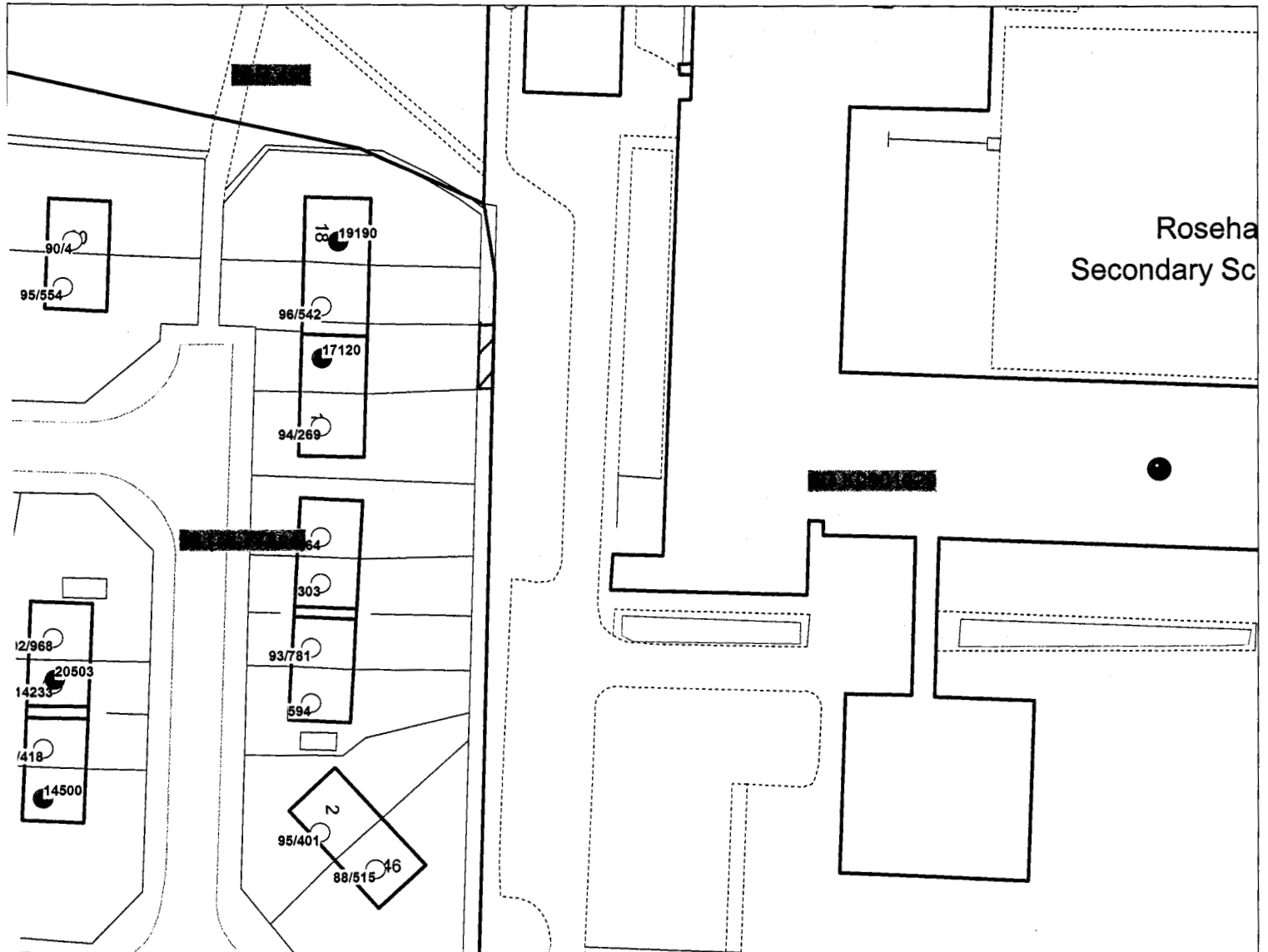

SCALE 1 : 683

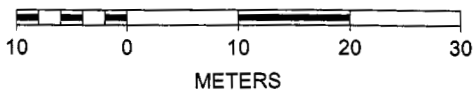

Property

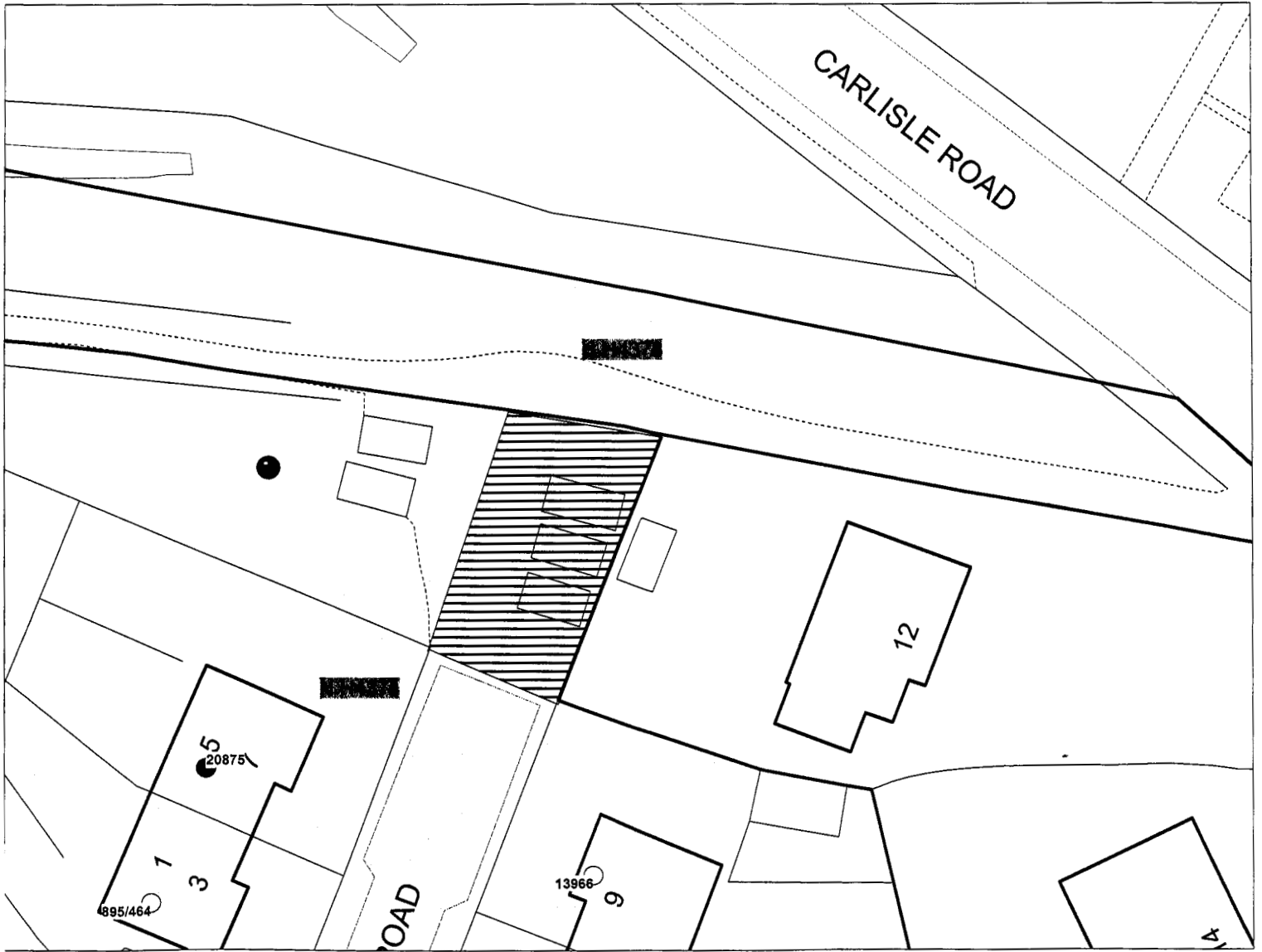

SCALE 1 : 455

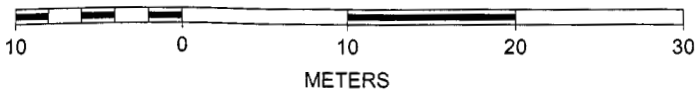

Property

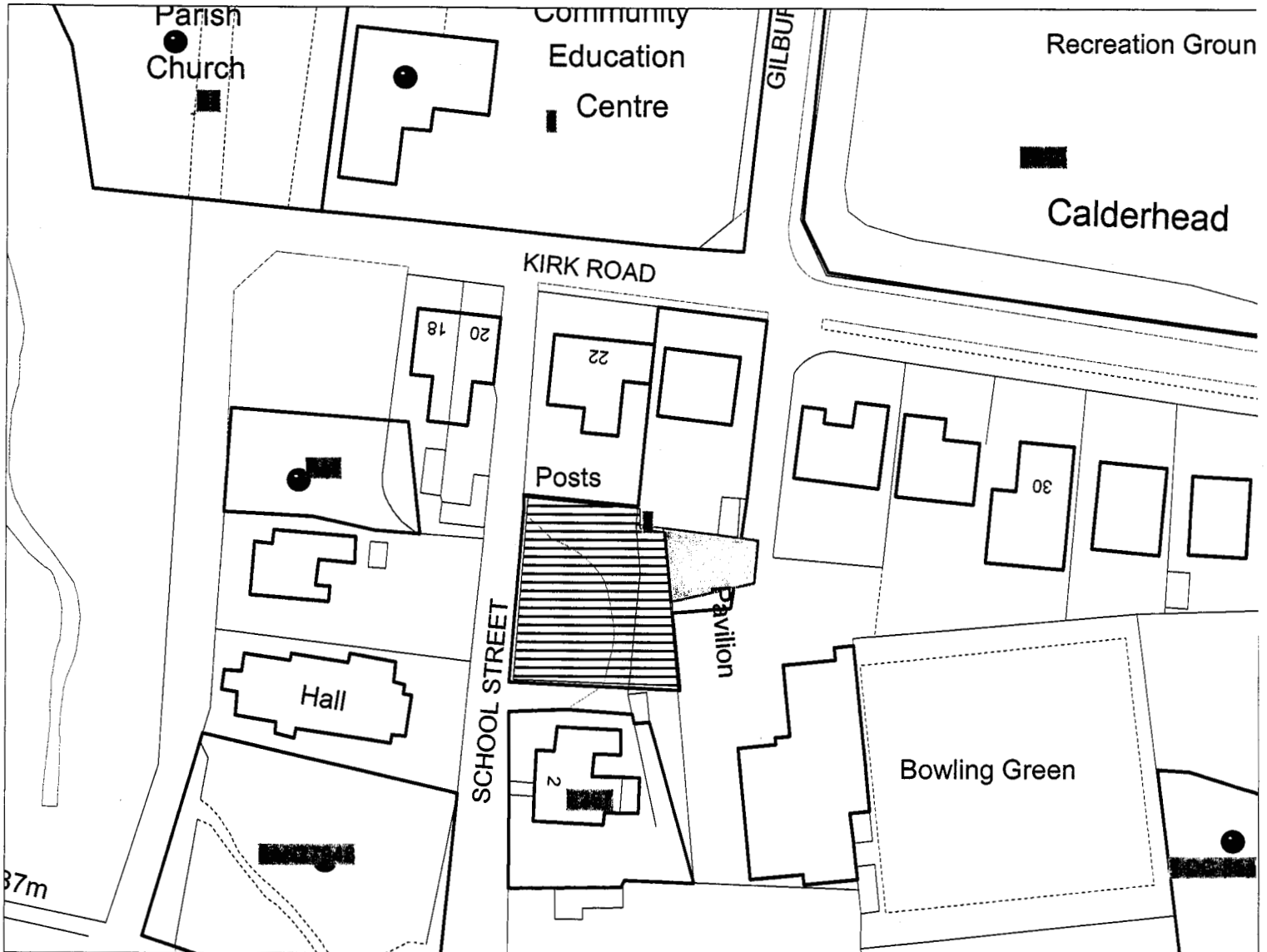

SCALE 1 : 909

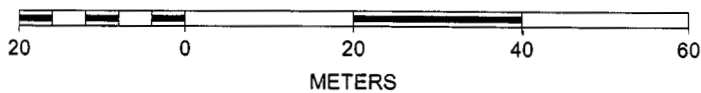

Property

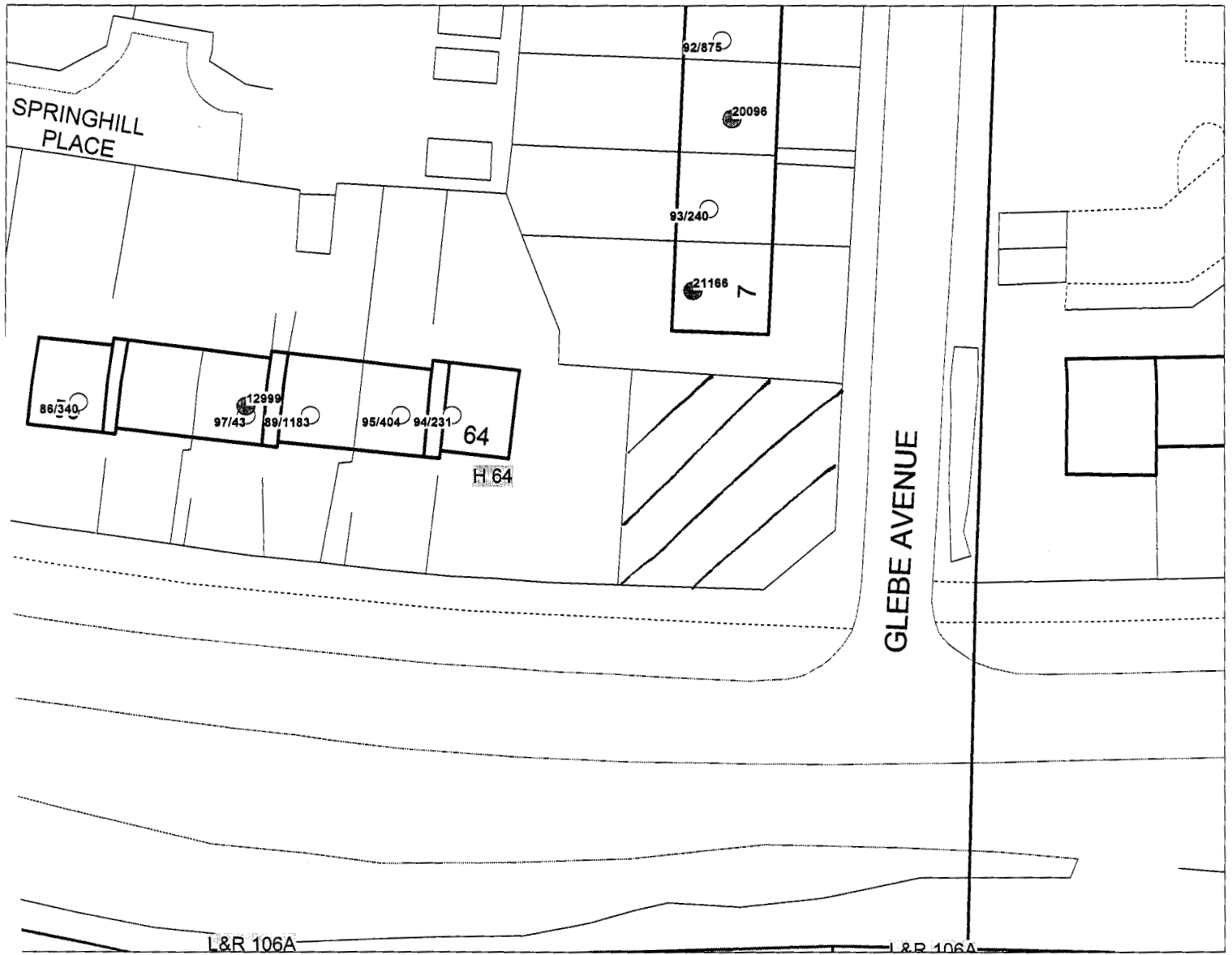

SCALE 1 : 479

