

**NORTH LANARKSHIRE COUNCIL**  
**REPORT**

<b>To: POLICY &amp; RESOURCES (PROPERTY) SUBCOMMITTEE</b>	<b>Subject:</b>
<b>From: HEAD OF PROPERTY SERVICES</b>	<b>LAND AT CLOUDEN ROAD, CUMBERNAULD.</b>
<b>Date: 17 March 2011</b>	<b>SUPERIORS' CONSENT</b>
	<b>Ref: DMcC-W4</b>

**1. INTRODUCTION**

- 1.1 This report concerns a request to grant Superiors' Consent for land at Clouden Road, Kildrum, Cumbernauld.

**2. BACKGROUND**

- 2.1 The land, as shown on the attached plan, was sold by Cumbernauld Development Corporation to The Salvation Army Trustee Company Limited on 9<sup>th</sup> March 1970.
- 2.2 The land was sold for the construction of a Salvation Army Hall and the remaining ground was to be used "exclusively for garden or planting or ornamental ground or parking area".
- 2.3 The Salvation Army is currently considering building an extension to the hall and has approached the Council as successors to Cumbernauld Development Corporation for consent to the development as Superior.

**3. DESCRIPTION**

- 3.1 The site lies to the west of the existing Salvation Army Hall in Clouden Road, Kildrum, Cumbernauld. The undeveloped area is open space grassed land and the site slopes from the north to the south. The surrounding area is predominately local authority housing.
- 3.2 The site is rectangular in shape and extends to 0.13 ha (0.32 acres) with the undeveloped area, as shown on the attached plan, being 500 sq.m (0.123 acres).
- 3.3 The Salvation Army intends to build an extension to the hall to provide a new foyer/reception area and main hall. The existing building extends to 250 sq.m and the extension will add a further 210 sq.m.

#### **4. NEGOTIATIONS**

4.1 Negotiations have taken place and a figure of One Thousand Pounds (£1,000) has been provisionally agreed with the Salvation Army for the granting of Superiors' Consent to allow the additional development to take place.

#### **5. CORPORATE CONSIDERATIONS**

5.1 The proposal to grant Superiors' Consent does not impact on Council operations.

5.2 The grant of Superiors' Consent will generate a capital receipt for the Council.

#### **6. RECOMMENDATIONS**

6.1 It is recommended that the council grants Superiors' Consent to the Salvation Army for the construction of an extension to the hall based on the terms detailed at 4.1 within this report.

6.2 All other terms and conditions to be adjusted by the Head of Property Services.



**IAN NISBET**  
Head of Property Services

Members seeking further information on the contents of this report are asked to contact Ian Nisbet, Head of Property Services, on 01236 616305.



# LOCATION PLAN - For Information Only

Title: Clouden Road

Scale 1:NTS



Town: Cumbernauld

Date: 31/01/11

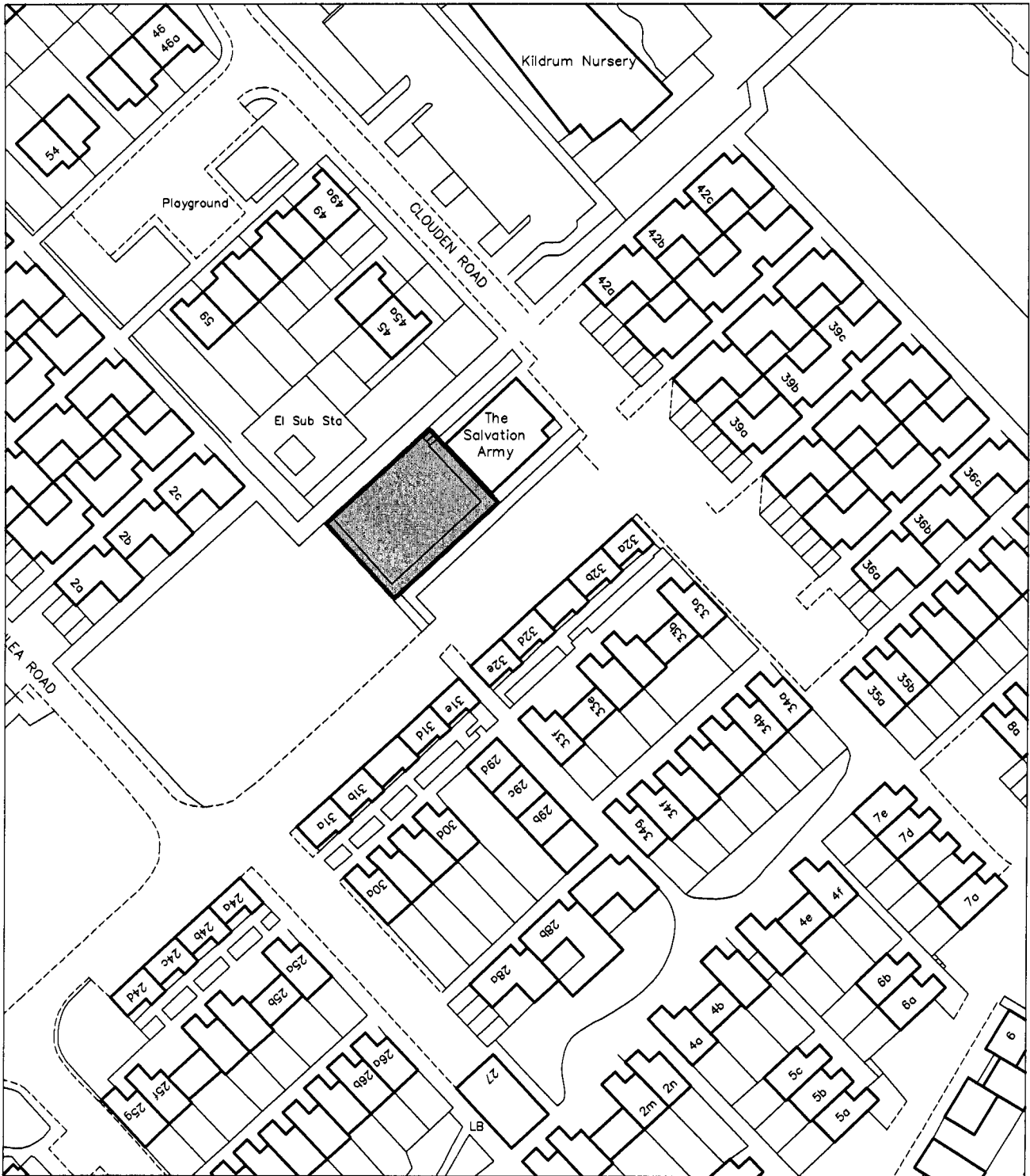

For Information Only

For Information Only

## Property Services

Reproduced from or based upon Ordnance Survey Mapping with the permission of the Controller of H.M. Stationery Office. Crown Copyright Reserved. Unauthorised reproduction infringes Crown Copyright and may lead to prosecution or civil proceedings. O.S. Licence Number LA 100023396

Executive Director of Corporate Services  
 North Lanarkshire Council  
 Fleming house  
 2 Tryst Road, Cumbernauld, G67 1JW