

To: SOCIAL WORK COMMITTEE	Subject: BELLSHILL - EMMA JAY ROAD - ALTERATIONS TO SOCIAL WORK OFFICES
From: ACTING DIRECTOR OF CONSTRUCTION SERVICES	
Date: 25 March 1999	<sup>AB</sup> AB/MP/SW/96/005

**(1.00) INTRODUCTION**

- (1.01) The purpose of this report is to keep Committee members informed regarding the above.
- (1.02) As Managing Agent for construction services project management duties to Service Departments this report is submitted after consultation with the Director of Social Work, details the project funding availability and proposed project management implementation arrangements designed and recommended to achieve cost effective, timeous and satisfactory project delivery.

**(2.00) RESOURCES**

- (2.01) The funding for this work is contained within the Social Work Accommodation Budget 1999/00.

**(3.00) CONSIDERATION**

- (3.01) Location :- Social Work Offices  
Emmay Jay Road  
Bellshill

Location plan attached

- (3.02) The works comprise alterations and adaptations to the existing Social Work Offices and former Job Centre to create additional accommodation.
- (3.03) The Tender documents were issued to six contractors of whom six submitted Tenders as follows:

<u>Contractor</u>	<u>Before Check</u>	<u>After Checking</u>
Meikle Construction Ltd, Coalburn	£189,828.99	£189,930.66
Fullwood Holdings Ltd, Bellshill	£201,733.16	£201,800.32
D Campbell & Co Ltd, Rutherglen	£225,298.02	£225,297.93
S B Contracts Ltd, Hamilton	£235,487.21	Not Checked
Murdoch MacKenzie Const.Ltd, Motherwell	£255,171.86	Not Checked
Cameron (Scotland) Ltd, Cumbernauld	£264,376.75	Not Checked

Report on Emma Jay Road, Alteration to Social Work Offices, Bellshill

(3.04) The project costs arising are as follows:-

Tender Costs	£ 189,930.66
Fees	£ 28,489.56
Total	£ 218,420.22

(3.05) The Tender of £189,930.66 submitted by Meikle Construction Ltd has been consistently and competitively priced and is worthy of consideration for acceptance. Funding is available for this project and any necessary associated fees.

(3.06) Planning Permission is being sought.

(3.07) Building Warrant is being sought.

(3.08) The Construction Phase Health and Safety Plan for this project is being compiled at present.

(4.00) RECOMMENDATION

(4.01) The Committee is asked to note that in accordance with the delegations given to the Director of Administration, this project is being progressed for acceptance, after consultation with the Convenor. Final confirmation on the project progress will be given at the meeting.

(4.02) Project Management arrangements will be introduced accordingly to achieve cost effective and project completion of this work.

(5.00) BACKGROUND PAPERS

(5.01) Held by the Acting Director of Construction Services.



Acting Director of Construction Services

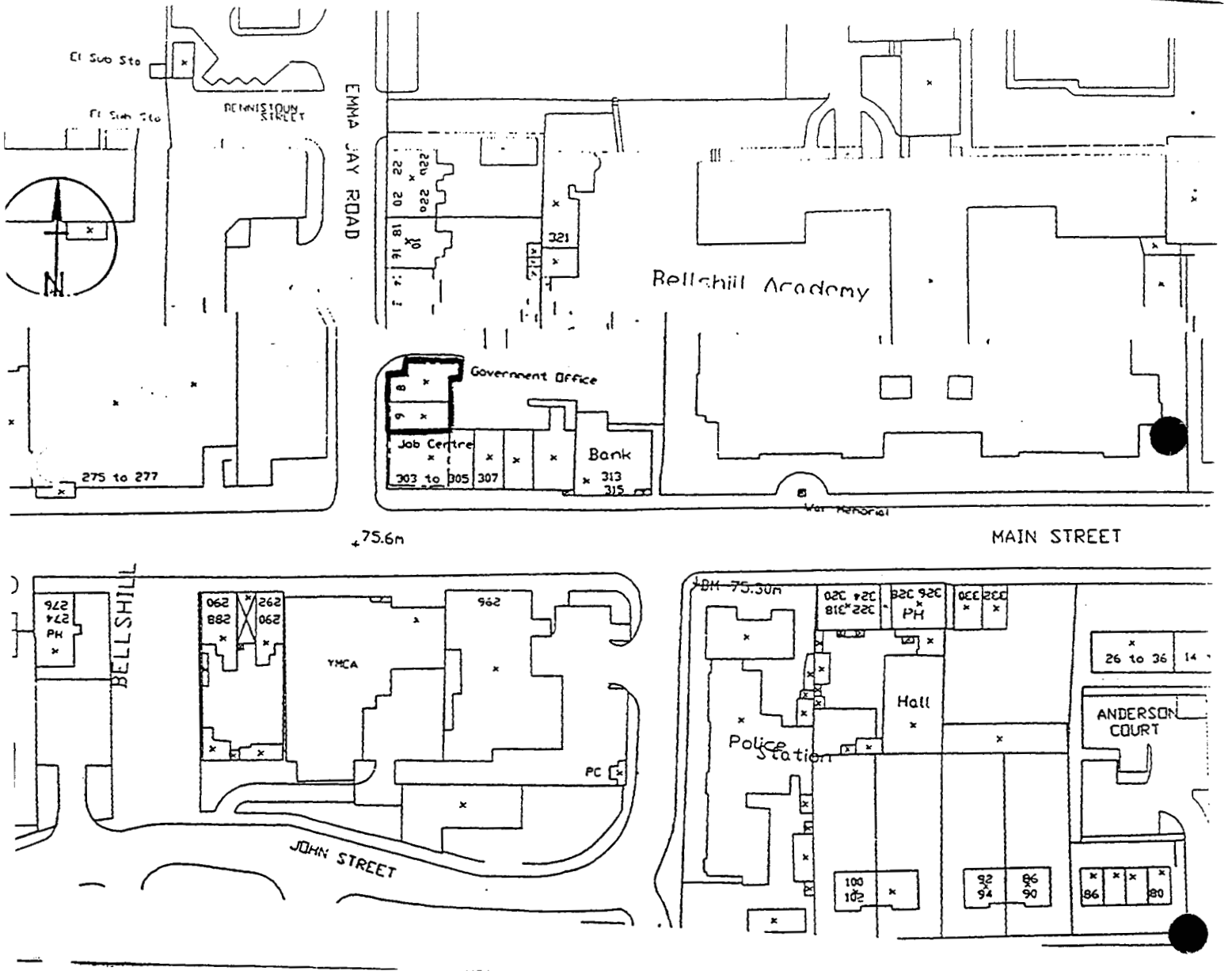

<p><b>LOCATION PLAN</b>          Social Work Office          6-8 Emma Jay Road          Bellshill          ML4 1HX</p>		<p>North Lanarkshire Council          Construction Services</p>	
		SCALE	No

## AGENDA ITEM No. ....5(6)

## NORTH LANARKSHIRE COUNCIL

## REPORT

TO: Social Work Committee	Subject: Bellshill - Emma Jay Road - Alterations to Social Work Offices.
FROM: Jim Dickie Director of Social Work	
DATE OF COMMITTEE: 8 June 1999	
REPORT AUTHOR: Jim Pitman	
REF: JRP/FS	

**1 INTRODUCTION**

- 1.1 The purpose of this report is to clarify the funding available for the alterations at the Social Work Office at Emma Jay Road, Bellshill.

**2 CURRENT POSITION**

- 2.1 The Acting Director of Construction Services has prepared a report for Committee recommending acceptance of a tender in regard to this contract.
- 2.2 The total cost of the tender including fees is £218,420.22.
- 2.3 The Social Work Capital Programme contains a specific brought forward sum for Emma Jay Road of £100,000. Included in the brought forward programme are the Bield Housing Project and alterations to Sir John Mann Home. The projected expenditure on these projects is likely to be less than the budget.
- 2.4 It is proposed to fund the additional expenditure on Emma Jay Road from the slippage on brought forward projects and from the minor works programme.

**3 RECOMMENDATIONS**

Committee is asked to note the reallocation of the capital programme to take account of actual costs now being identified

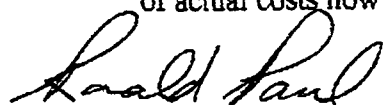

Jim Dickie  
Director of Social Work